

INSTALLATION INSTRUCTIONS FOR THE KDF30P DUAL STAGE PURIFICATION SYSTEM

Connecting to water supply: This kit is supplied with an SV-1 valve designed for connecting between a mixer tap inlet connection and the screw-on braided stainless water pipe connection,. The valve should be fitted before thread tapping and installing the shut-off tap hand tight only. **Do not over tighten.**

Where older style taps are fitted with copper or polybutylene pipe an SV-6 valve should be used. When installing this, the spike must be retracted by turning the shut-off tap anti-clockwise before mounting the valve on the cold water pipe. Adjust the brass screw, place saddle valve over the pipe and insert the support bar against the pipe. Tighten into place away from bends and in a position that gives you easy access to the shut off tap and access for connecting the tubing and fittings. Run the hot water to ensure you have connected to the correct pipe. **Do not puncture the pipe until system is fully assembled.**

Connecting the tubing: The SV-1 tap valve has a push fit tube connection. You must ensure the tube is fully pushed in. To create a seal.

Assemble the SV-6 as shown in the Install Valve diagram.

Setting up the filter unit: Tube connector fittings are installed in either end of the filter cartridge.

Check the flow direction and push fit the hoses.

Use sufficient hose so that tubing is not pulled or crimped.

Faucet Installation: Position the faucet, normally at the corner of the sink. Check underneath to ensure there are no obstructions. On stainless steel you may need to centre punch, then start with a small drill and work up to 12mm. On wood, formica or laminate use a 12mm butterfly wood bit. Assemble faucet as shown in the diagram. Some faucets may vary and these should have instructions on the back of the box.

Testing: Open the lever on the faucet by flicking it up.

SV-1: Open the valve tap part way and allow water to flow from the faucet. Ensure flow is not excessive.

SV-6: Tighten the saddle valve tap until it has fully punctured the pipe then open again.

Once water is flowing from the faucet, lower the lever and check for leaks. Do not over tighten fittings, just enough to keep the system water tight.

If you have any doubts at all about whether you have the right fittings for this in your kitchen, call a qualified plumber who will warranty their work.

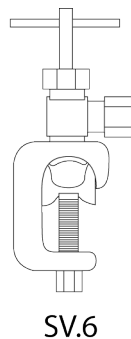
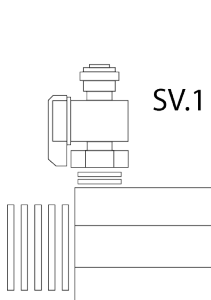
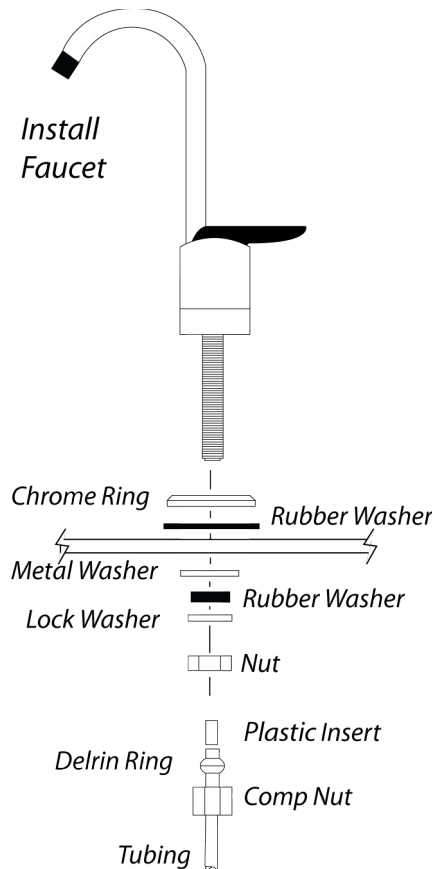

Install Valve

